

SECTION

8

STAINLESS STEEL FITTINGS  
& RIGGING HARDWARE



**EXCEL STAINLESS STEEL MASTER LINK**

Product Code	Part No.	WLL (t)	Chain Size		A (mm)	B (mm)	C (mm)	Weight (kg)
			(mm) 1 leg	(mm) 2 legs				
02480006	MS 13 I	0.75	6	-	110	60	13	0.34
02480008	MS 16 I	1.25	8	6	110	60	16	0.53
02480010	MS 18 I	2.00	10	8	135	75	18	0.82
02480013	MS 22 I	3.20	13	10	160	90	22	1.50
02480016	MS 26 I	5.00	16	13	180	100	26	2.31



**STAINLESS STEEL MULTI LINK**

Product Code	Part No.	WLL (t)	Chain Size		A (mm)	B (mm)	C (mm)	a (mm)	b (mm)	Dia (mm)	Weight (kg)
			(mm) 3/4 legs	(mm)							
02480106	MTS 18 I	1.60	6	135	75	18	54	25	13	1.16	
02480108	MTS 22 I	2.65	8	160	90	22	70	34	16	2.22	
02480110	MTS 26 I	4.25	10	180	100	26	85	40	18	3.37	
02480113	MTS 32 I	6.70	13	200	110	32	115	50	22	6.07	

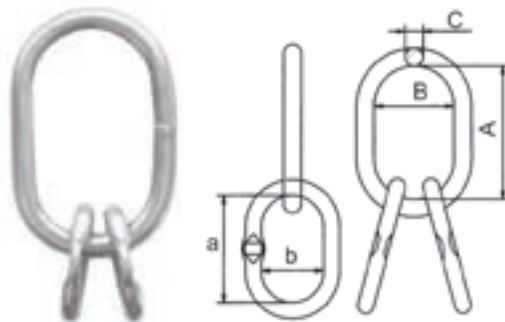

**EXCEL STAINLESS STEEL EYE SLING HOOK**

Product Code	Part No.	WLL (t)	Chain Size (mm)	A (mm)	B (mm)	P (mm)	C (mm)	Weight (kg)
02483106	CSO 5/6 I	0.70	5/6	86	24	28	16	0.25
02483108	CSO 7/8 I	1.20	7/8	102	26	29	19	0.53
02483110	CSO 10 I	1.60	10	121	35	31	22	0.90
02483113	CSO 13 I	2.70	13	154	41	40	31	1.75



**EXCEL STAINLESS STEEL SLING HOOK**

Product Code	Part No.	WLL (t)	Chain Size (mm)	A (mm)	B (mm)	P (mm)	Weight (kg)
02483006	CSC 5/6 I	0.70	5/6	73	16	28	0.26
02483008	CSC 7/8 I	1.20	7/8	95	20	29	0.49
02483010	CSC 10 I	1.60	10	110	24	31	0.94
02483013	CSC 13 I	2.70	13	138	31	40	1.80



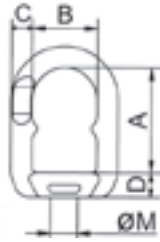

## EXCEL STAINLESS STEEL EYE NUT

Product Code	Part No.	WLL (t)	Size (mm)	A (mm)	B (mm)	C (mm)	D (mm)	Weight (kg)
02486012	EL 12 I	0.60	12	48	32	15	13	0.12
02486016	EL 16 I	1.00	16	60	37	17	15	0.16
02486020	EL 20 I	2.00	20	60	37	17	15	0.20
02486024	EL 24 I	3.00	24	75	47	22	19	0.24

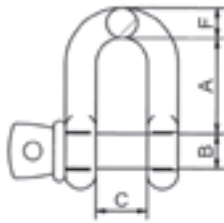

## STAINLESS STEEL SCREW TYPE DEE SHACKLE

Product Code	Part No.	WLL (t)	A (mm)	F (mm)	B (mm)	C (mm)	Weight (kg)
02488010	MDV 0.6 I	0.60	38	9.5	10	20	0.11
02488012	MDV 0.9 I	0.90	50	12	12	25	0.25
02488016	MDV 1.5 I	1.50	52	13	16	24	0.40
02488020	MVD 2.5 I	2.50	65	16	20	28	0.60
02488022	MVD 3 I	3.00	72	19	22	30	0.22
02488025	MVD 4 I	4.00	78	19	25	32	0.25

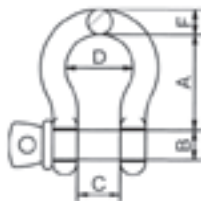

## STAINLESS STEEL SCREW TYPE ANCHOR SHACKLE

Product Code	Part No.	WLL (t)	A (mm)	F (mm)	B (mm)	C (mm)	D (mm)	Weight (kg)
02489010	MLV 0.6 I	0.60	36	9.5	10	20	27	0.11
02489012	MLV 0.9 I	0.90	47	12	12	25	37	0.25
02489016	MLV 1.5 I	1.50	47	13	16	25	33	0.37
02489020	MLV 2.5 I	2.50	60	16	20	28	42	0.65
02489022	MLV 3 I	3.00	67	19	22	30	51	1.00
02489025	MLV 4 I	4.00	84	22	25	36	57	1.70



## STAINLESS STEEL EYEBOLT

Product Code	Part No.	WLL (t)	Size (mm)	A (mm)	B (mm)	L (mm)	C (mm)	Weight (kg)
02487010	AL 10 I	0.40	10	19	22	29	8	0.07
02487012	AL 12 I	0.60	12	22	27	36	9	0.13
02487016	AL 16 I	1.00	16	30	36	53	12	0.36
02487020	AL 20 I	2.00	20	32	40	59	16	0.55
02487024	AL 24 I	3.00	24	42	54	64	18	1.08

## STAINLESS STEEL OMEGA LINK

Product Code	Part No.	WLL (t)	Size (mm)	A (mm)	B (mm)	C (mm)	Weight (kg)
02481006	CO 6 I	0.70	6	45	41	16	0.12
02481008	CO 7/8 I	1.20	7/8	55	52	20	0.16
02481010	CO 10 I	1.60	10	73	70	25	0.33
02481013	CO 13 I	2.70	13	92	85	29	0.70

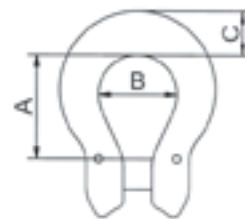

## FORGED CARBON STEEL HOIST HOOK

• Finish: Zinc Plated

Product Code	WLL (kg)	Overall Length (in)	Eye I.D (in)
09564505	750	7.3	0.75
09564506	1000	4.9	1.0
09564507	1500	5.5	1.1
09564508	2000	6.5	1.3
09564509	3000	7.8	1.6



## STAINLESS STEEL EYE HOOK

• Material: Stainless Steel (AISI 316)

**⚠ NOT SUITABLE FOR LIFTING APPLICATIONS**

Product Code	WLL (kg)	Overall Length (mm)	Eye I.D (mm)
09564510	400	105	19
09564512	500	120	28



## EYE HOOK

• Finish: Zinc Plated

**⚠ NOT SUITABLE FOR LIFTING APPLICATIONS**

Product Code	WLL (kg)	Overall Length (mm)	Eye I.D (mm)
09564740	3.55	89	18



## SECURITY EYE HOOK #3033

• Finish: Zinc Plated

**⚠ NOT SUITABLE FOR LIFTING APPLICATIONS**

Product Code	WLL (kg)	Overall Length (mm)	Eye I.D (mm)
09564735	3.405	135	26.1





### SWIVEL BOLT SNAP (“DOG CLIP”)

⚠ NOT SUITABLE FOR LIFTING APPLICATIONS

Product Code (Brass)	Product Code (Nickel Plated)	Eye Dia. (mm)	Overall Length (mm)
09564631	09564632	12	75
09564633	09564634	19	76
09564635	09564636	25	88
09564637	09564638	32	114



### STAINLESS STEEL “S” HOOK

⚠ NOT SUITABLE FOR LIFTING APPLICATIONS

Product Code	Material Dia. (mm)	Overall Length (mm)
09564303	9.5	90



### PLASTIC COATED “S” HOOK

⚠ NOT SUITABLE FOR LIFTING APPLICATIONS

Product Code	Material Dia. (mm)	Material Dia. (mm)
09564302	8.0	8.0



### ZINC PLATED “S” HOOK

⚠ NOT SUITABLE FOR LIFTING APPLICATIONS

Product Code	Material Dia. (mm)	Overall Length (mm)
09564301	10	105



### TESTED ZINC PLATED STEEL QUICKLINKS GENUINE MAILLON RAPIDES IMPORTED FROM FRANCE

Product Code	WLL (kg)	MBL (kg)	Overall Length (mm)
09569608	700	3,500	74
09569610	1100	5,500	89
09569612	1500	7,500	104
09569616	2900	14,500	140



### LONGLINK QUICKLINK GENUINE MAILLON RAPIDES IMPORTED FROM FRANCE

Product Code	WLL (kg)	MBL (kg)	Overall Length (mm)
09569712	1250	6250	120

## TESTED STAINLESS STEEL QUIKLINKS GENUINE MAILLON RAPIDES IMPORTED FROM FRANCE

Product Code	WLL (kg)	MBL (kg)	Overall Length (mm)
09569508	1,100	5,500	74
09569510	1,800	9,000	89
09569512	2,500	12,500	104
09569516	4,500	22,500	140



## COMMERICAL UNTESTED STAINLESS STEEL QUIKLINKS

• Material: Stainless Steel (AISI 304)

**⚠ NOT SUITABLE FOR LIFTING APPLICATIONS**

Product Code	Size (mm)	Overall Length (mm)
09569460	6	60
09569480	8	75
09569500	10	90



## STAINLESS STEEL PEAR SHAPED SNAP WITH SREWGATE

• Material: Stainless Steel (AISI 316)

**⚠ NOT SUITABLE FOR LIFTING APPLICATIONS**

Product Code	Size (mm)	Overall Length (mm)
09569310	8.0	80
09569315	10.0	100
09569316	12.0	140



## ZINC PLATED SNAP HOOK (KARABINER)

**⚠ NOT SUITABLE FOR LIFTING APPLICATIONS**

Product Code	Size (mm)	Overall Length (mm)
09569006	6	60



## STAINLESS STEEL SNAP HOOK (KARABINER)

• Material: Stainless Steel (AISI 316)

**⚠ NOT SUITABLE FOR LIFTING APPLICATIONS**

Product Code	Size (mm)	Overall Length (mm)
09569060	6	60
09569080	8	80
09569100	10	100



## STAINLESS STEEL SNAP HOOK WITH EYE (KARABINER)

• Material: Stainless Steel (AISI 316)

**⚠ NOT SUITABLE FOR LIFTING APPLICATIONS**

Product Code	Size (mm)	Overall Length (mm)
09569160	6	60
09569180	8	80
09569200	10	100
09569240	11	120





### STAINLESS STEEL SWIVEL BULL SNAP

- Material: Stainless Steel (AISI 316)
- ⚠ **NOT SUITABLE FOR LIFTING APPLICATIONS**

Product Code	Overall Length (mm)	Eye I.D (mm)
09569000	105	25



### STAINLESS STEEL SPRING EYE HOOK

- Material: Stainless Steel (AISI 316)
- ⚠ **NOT SUITABLE FOR LIFTING APPLICATIONS**

Product Code	Size (mm)	Overall Length (mm)
09568768	6	50
09568770	10	70
09568800	13	100



### COMMERCIAL DEE SHACKLES (STAINLESS STEEL)

- Material: Stainless Steel (AISI 316)
- Finish: Electro-Polished
- ⚠ **NOT SUITABLE FOR LIFTING APPLICATIONS**
- SHACKLES: DIMENSIONS & MASSES ARE SUBJECT TO COMMERCIAL TOLERANCES AND DESIGN CHANGES WITHOUT NOTICE.

Product Code	Pin & Body Dia. (mm)	Working Load (mm)	Inside Width	Overall Length (mm)	Approx Weight (kg)
09568405	5	.04	10	32	.02
09568406	6	.10	13	36	.03
09568408	8	.20	16	48	.06
09568410	10	.30	20	58	.12
09568412	12	.50	25	70	.19
09568416	16	.80	31	95	.41



### COMMERCIAL WIRE ROPE THIMBLES (STAINLESS STEEL)

- Material: Stainless Steel (AISI 304)
- Finish: Electro-Polished
- ⚠ **NOT SUITABLE FOR LIFTING APPLICATIONS**
- LARGER SIZES IMPORTED TO ORDER WIRE ROPE THIMBLES: DIMENSIONS & MASSES ARE SUBJECT TO COMMERCIAL TOLERANCES AND DESIGN CHANGES WITHOUT NOTICE.

Product Code	Wire Rope Dia. (mm)	Overall Length (mm)
02106720	2	14
02106730	3	17
02106740	4	18
02106750	5	21
02106760	6	25
02106780	8	30
02106800	10	36



### COMMERCIAL WIRE ROPE GRIPS (STAINLESS STEEL)

- Material: Stainless Steel (AISI 304)
- Finish: Electro-Polished
- Larger Size Imported To Order
- ⚠ **NOT SUITABLE FOR LIFTING APPLICATIONS**
- WIRE ROPE GRIPS: DIMENSIONS & MASSES ARE SUBJECT TO COMMERCIAL TOLERANCES AND DESIGN CHANGES WITHOUT NOTICE.

Product Code	Wire Rope Dia. (mm)	Nett Weight (kg)
09568303	3	0.01
09568304	4	0.02
09568305	5	0.03
09568306	6	0.04
09568308	8	0.05
09568310	10	0.15

## COMMERCIAL QUALITY STAINLESS STEEL TURNBUCKLES

- Thread: Metric
- Material: Stainless Steel (AISI 304)
- Finish: Electro-Polished
- Ends: Eye+Eye

⚠ NOT SUITABLE FOR LIFTING APPLICATIONS

Product Code	Thread Size	Overall Length (mm) Max.	Overall Length (mm) Min.	Approx. Breaking Load (kg)
09568505	M5	160	120	160
09568506	M6	220	150	400
09568508	M8	290	200	800
09568510	M10	360	250	1,200



## COMMERCIAL QUALITY STAINLESS STEEL RIGGING SCREWS

- Thread: Metric
- Material: Stainless Steel (AISI 304)
- Finish: Electro-Polished
- Ends: Jaw + Jaw

⚠ NOT SUITABLE FOR LIFTING APPLICATIONS

RIGGING SCREWS: DIMENSIONS & MASSES ARE SUBJECT TO COMMERCIAL TOLERANCES AND DESIGN CHANGES WITHOUT NOTICE.

Product Code	Thread Size	Overall Length (mm) Max.	Overall Length (mm) Min.	Hole Dia. (mm)	Approx. Breaking Load (kg)
09568545	M5	190	130	5.0	1,000
09568546	M6	210	140	6.0	1,600
09568548	M8	240	165	8.0	3,000
09568550	M10	270	190	9.5	4,000
09568552	M12	360	245	12.0	6,400
09568554	M14	400	270	12.0	8,400
09568556	M16	450	310	14.0	9,600



## COMMERCIAL STAINLESS STEEL EYEBOLT

- Material: Stainless Steel (AISI 304)
- Finish: Polished
- Supplied With Nut & 2 Washers

⚠ NOT SUITABLE FOR LIFTING APPLICATIONS

Product Code	Thread Size	Overall Length (mm)	Thread Length (mm)	Eye Diameter (mm)
09568716	M6	100	74	13
09568718	M8	130	92	16
09568720	M10	150	90	22



## STAINLESS STEEL SWIVELS

- Material: Stainless Steel (AISI 304)

⚠ NOT SUITABLE FOR LIFTING APPLICATIONS

Product Code (Eye + Eye)	Product Code (Jaw + Jaw)	Size (mm)	Overall Length (mm)
09568606		6	70
09568608		8	90
09568609		9	100
	09568620	10	115



## STAINLESS STEEL PULLEYS

- Stainless Steel (AISI 316)
- Commercial Grade (Untested)
- Available in Single & Double Sheave Models
- Sheave Oval Eye

⚠ NOT SUITABLE FOR LIFTING APPLICATIONS

Product Code (Single Sheave)	Product Code (Double Sheave)	Sheave Dia. (mm)	Max Rope Dia. (mm)	Weight Single Sheave (kg)	Weight Double Sheave (kg)
09568725	09568726	25	8	0.14	0.22
09568732	09568733	32	10	0.19	0.30
09568750	09568751	50	12	0.40	0.64



## ZINC PLATED SINGLE SWIVEL EYE PULLEY

- Material: Zinc Plated

⚠ NOT SUITABLE FOR LIFTING APPLICATIONS

Product Code	Size (mm)	WLL (kg)	Weight (kg)
09568765	75	300	0.40



## STAINLESS STEEL RINGS

- Material: Stainless Steel (AISI 304)
- ⚠ NOT SUITABLE FOR LIFTING APPLICATIONS



Product Code	Material Dia. (mm)	Inside Dia. (mm)
09564784	5	25
09564787	6	30
09564788	6	38
09564795	8	50
09564798	10	65

## STAINLESS STEEL DEE RINGS

- Material: Stainless Steel (AISI 304)
- ⚠ NOT SUITABLE FOR LIFTING APPLICATIONS



Product Code	Material Dia. (mm)	Inside Dia. (mm)
09564801	5	25
09564802	6	38
09564803	8	50

## STAINLESS STEEL SPARE RATCHET BUCKLE

- Material: Stainless Steel (G304)

Product Code	Size (mm)	MBL (kg)
09563007	25	1500
09563015	38	3000
09563028	50	4000



25mm



38mm



50mm